

TIME CONTROL SYSTEM

Schematic

CAUTION:
Never touch the terminals of time control unit with bare hands.

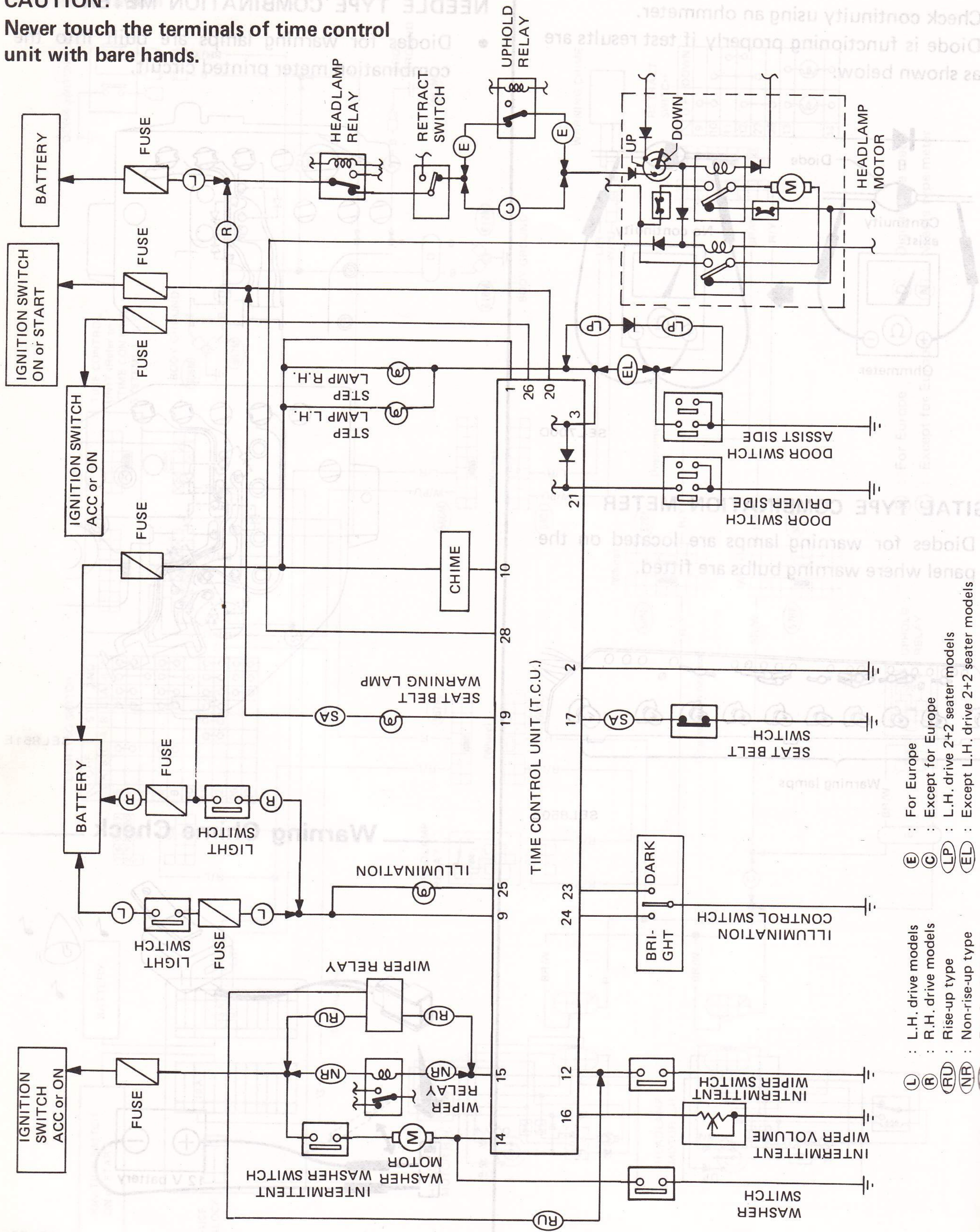

SEL852E

TIME CONTROL SYSTEM

Wiring Diagram

L.H. drive model

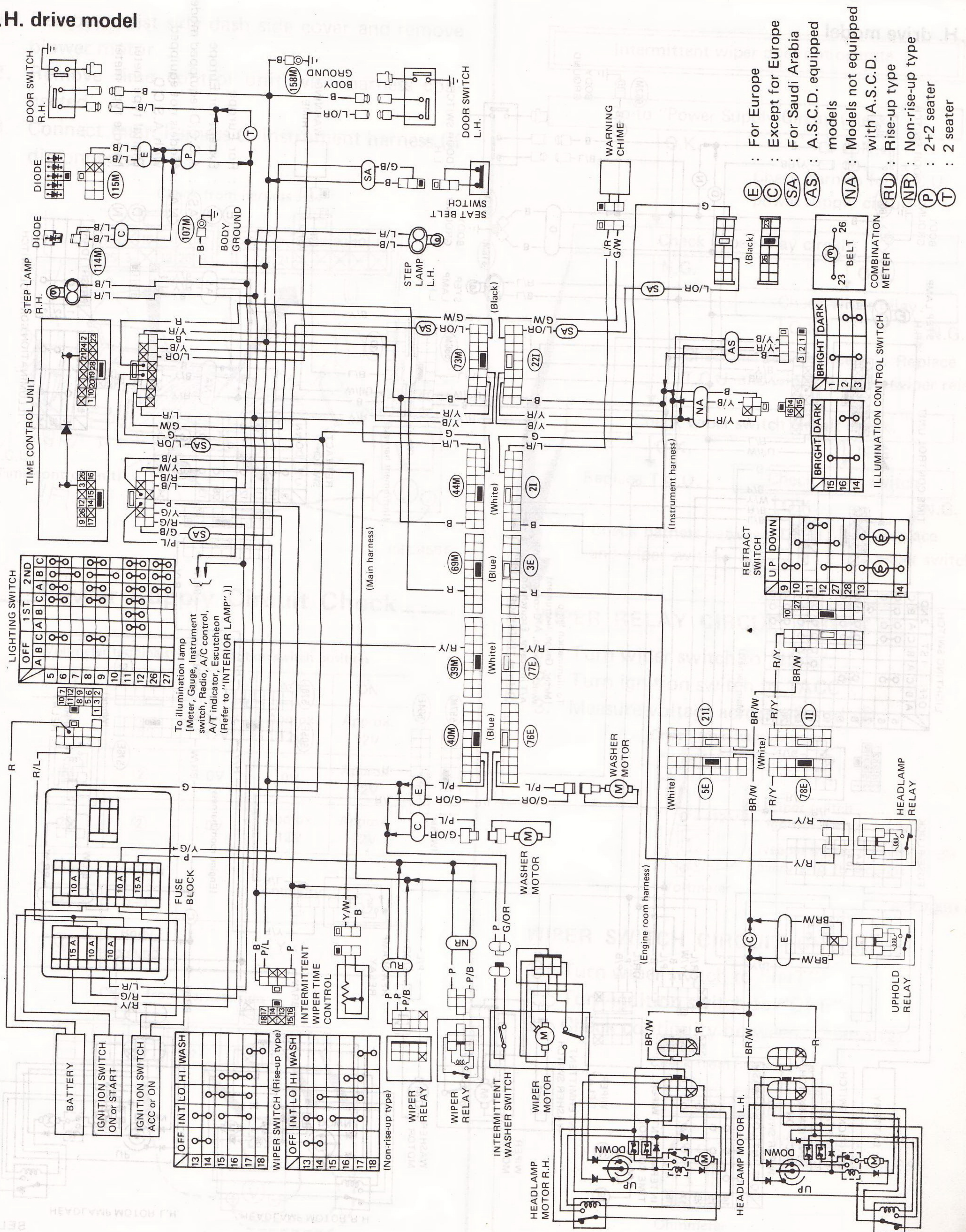

SEL853E

TIME CONTROL SYSTEM

Preparation for Trouble-shooting

1. Remove assist side dash side cover and remove blower motor.
2. Remove time control unit with harness connected.
3. Connect main harness to instrument harness (if disconnected).

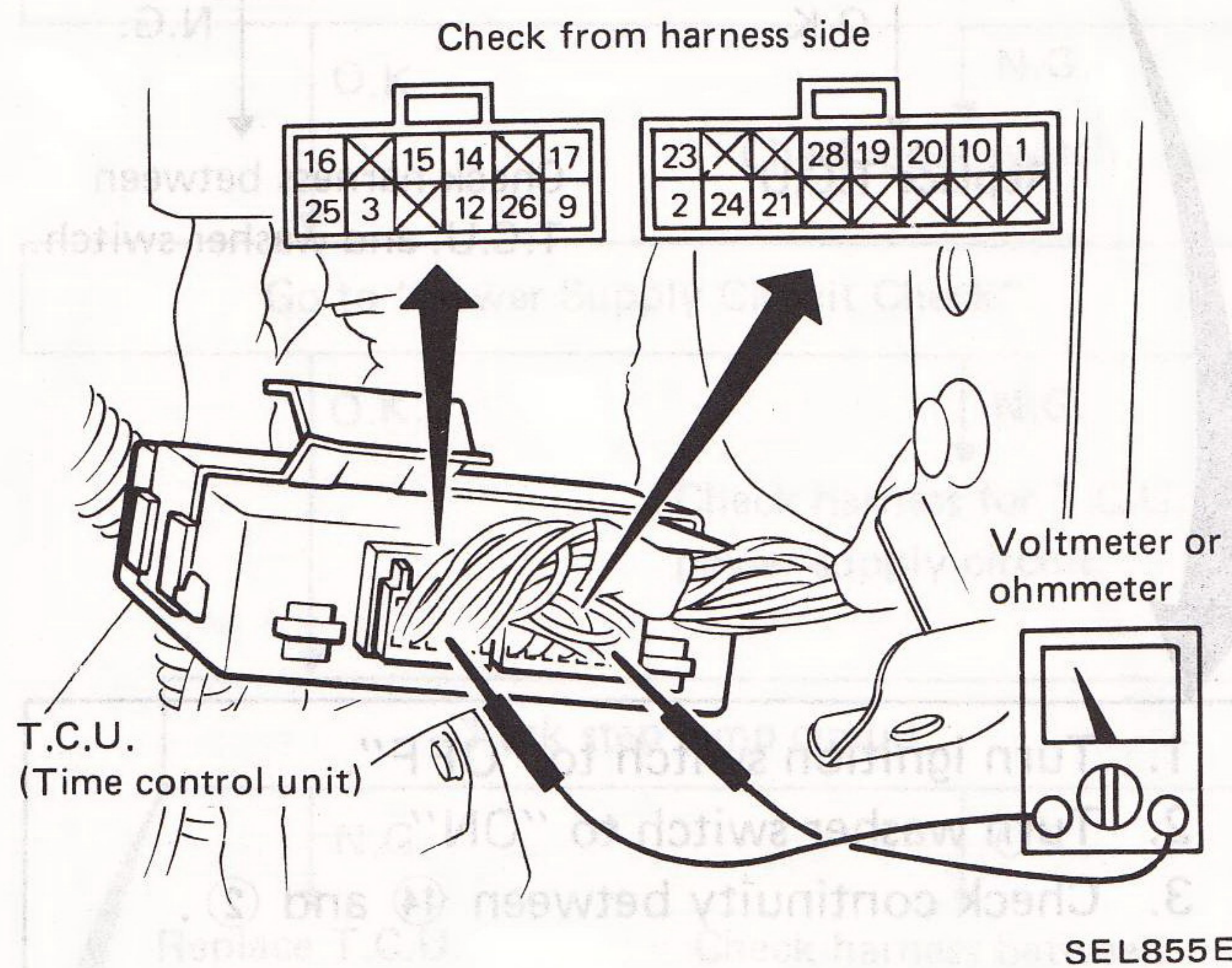

Power Supply Circuit Check

Voltmeter terminals		Ignition switch position		
(+)	(-)	OFF	ACC	ON
①	②	Approx. 12V	Approx. 12V	Approx. 12V
⑳	②	0V	0V	Approx. 12V
⑳	②	0V	Approx. 12V	Approx. 12V
Ohmmeter terminals		Continuity		
(+)	(-)			
②	Body ground	Yes		

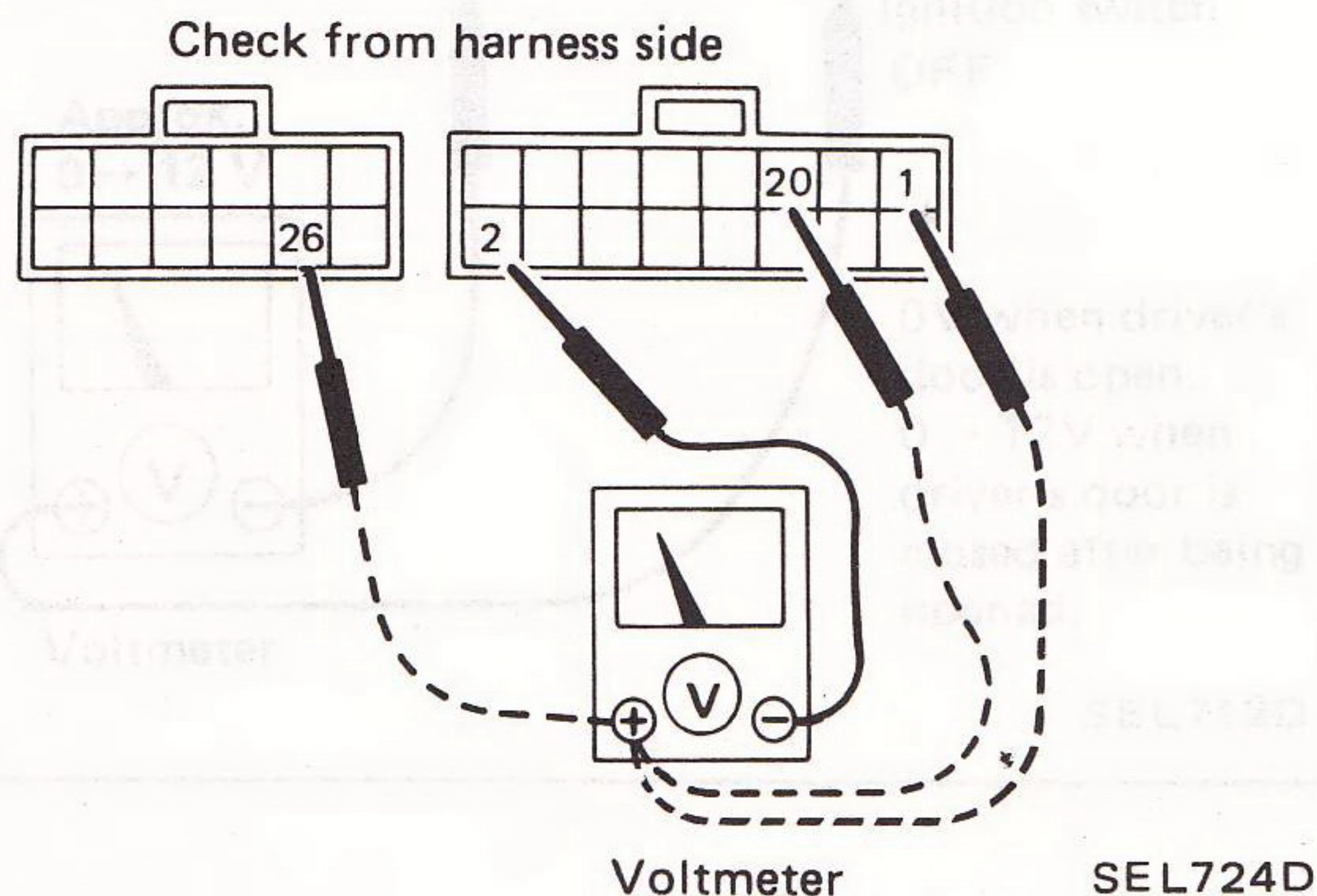

Trouble-shooting

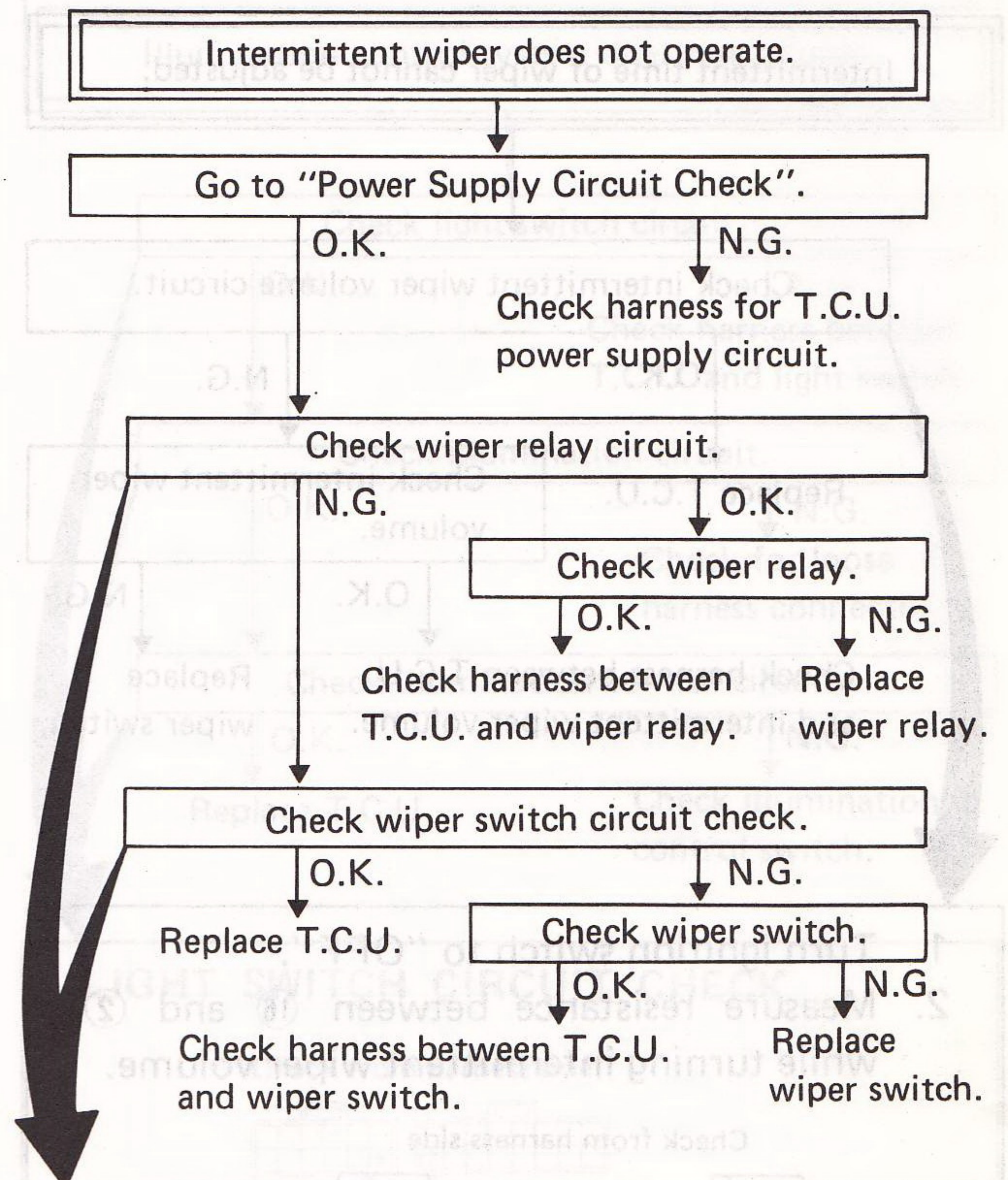

WIPER RELAY CIRCUIT CHECK

1. Turn wiper switch to "INT".
2. Turn ignition switch to "ACC".
3. Measure voltage across ⑮ and ②.

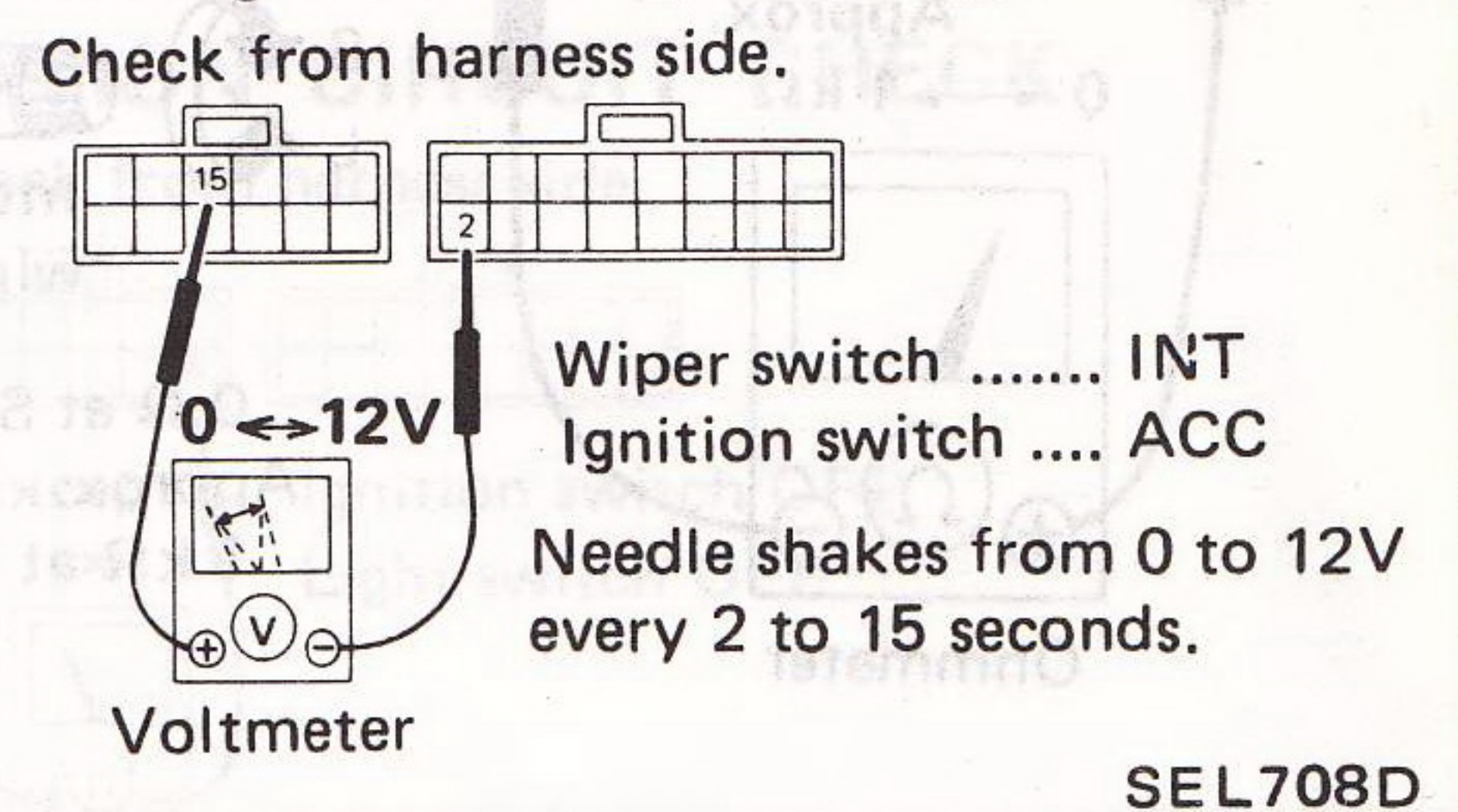

WIPER SWITCH CIRCUIT CHECK

1. Turn wiper switch to "INT".
2. Turn ignition switch to "OFF".
3. Check continuity between ⑫ and ②.

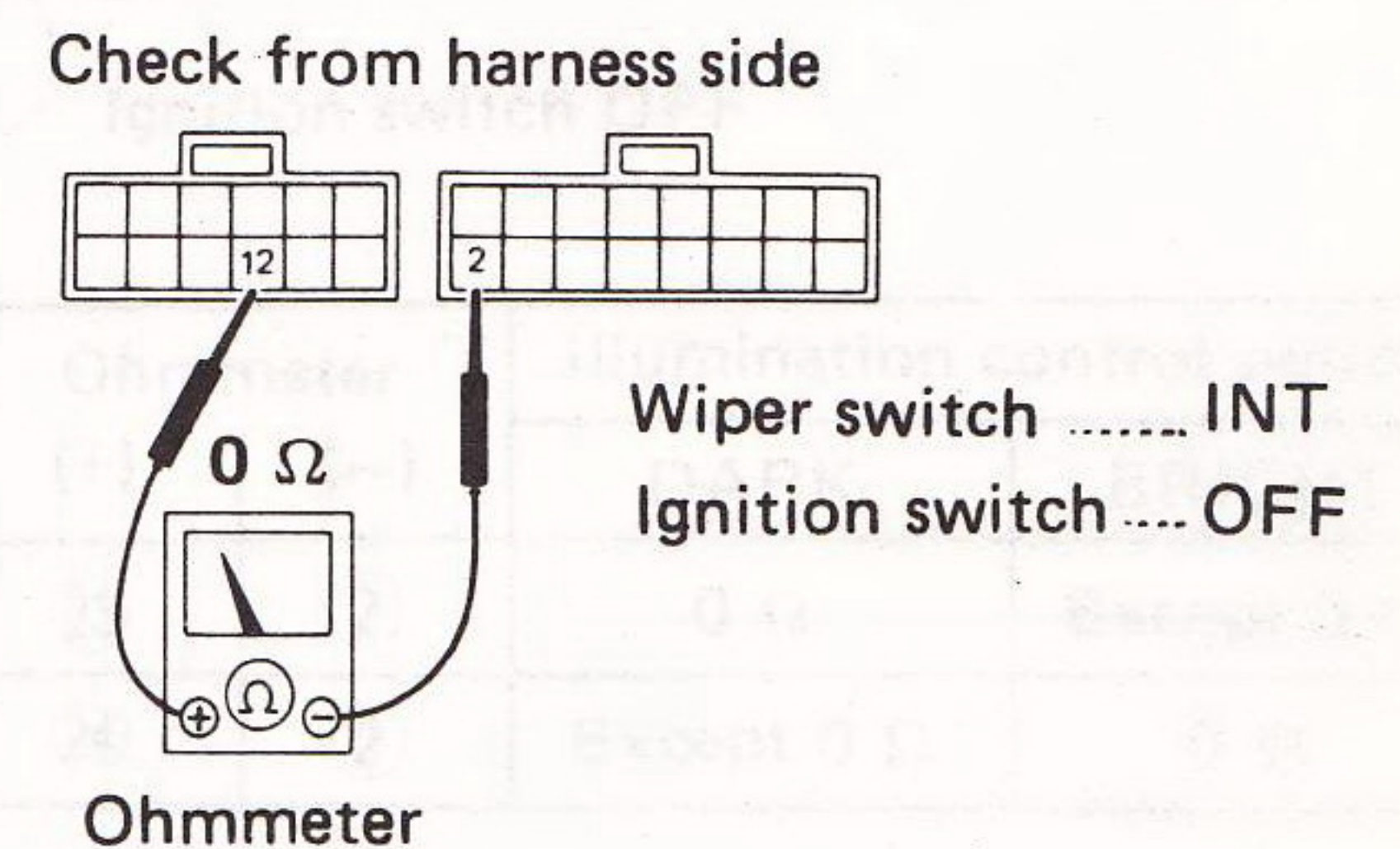

TIME CONTROL SYSTEM

Trouble-shooting (Cont'd)

Intermittent time of wiper cannot be adjusted.

Check intermittent wiper volume circuit.

O.K.

Replace T.C.U.

N.G.

Check intermittent wiper volume.

O.K.

Check harness between T.C.U. and intermittent wiper volume.

N.G.

Replace wiper switch.

1. Turn ignition switch to "OFF".
2. Measure resistance between ⑩ and ② while turning intermittent wiper volume.

Check from harness side

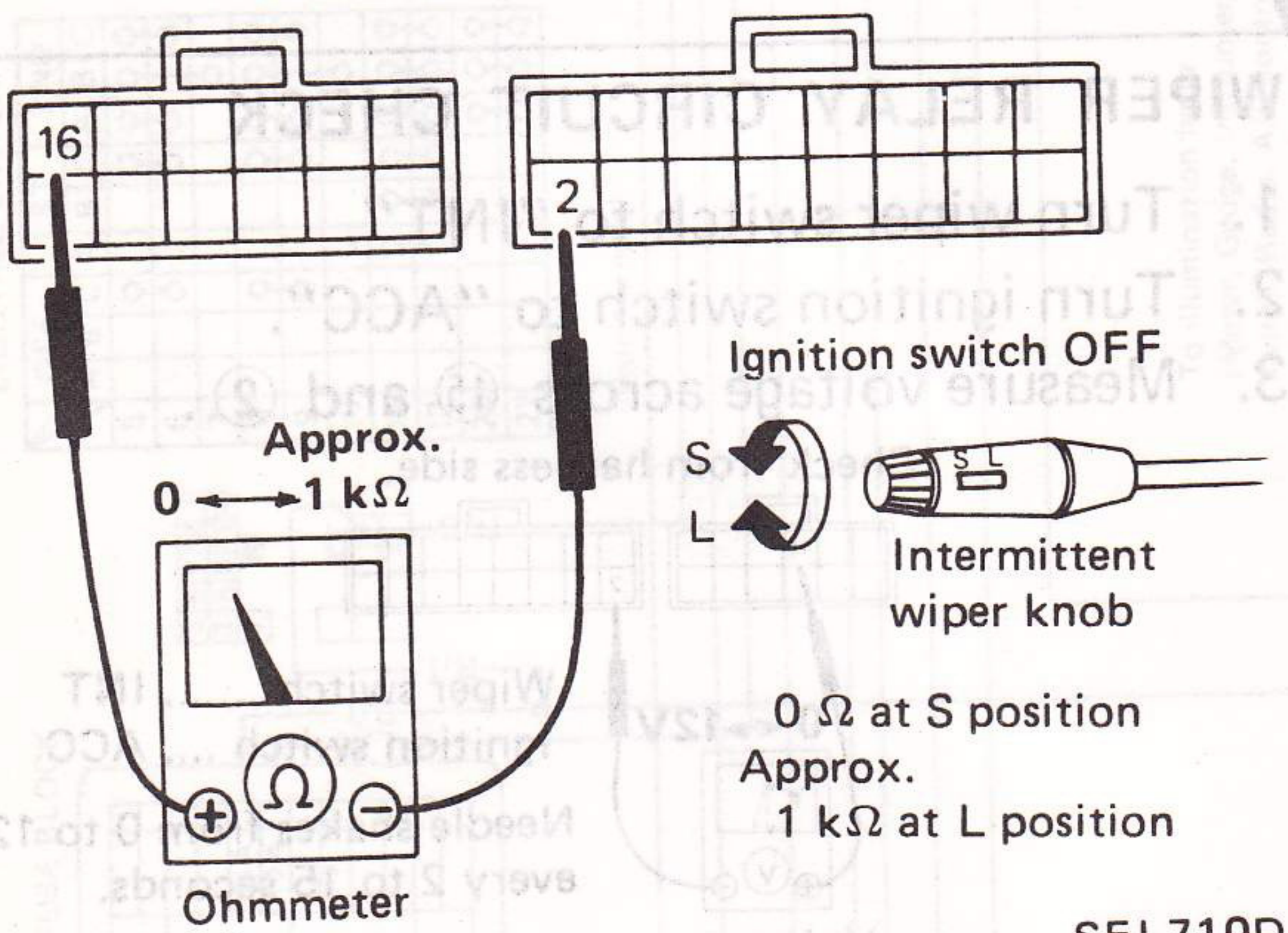

Wiper and washer activate individually but not in combination.

Check washer switch circuit.

O.K.

Replace T.C.U.

N.G.

Check harness between T.C.U. and washer switch.

1. Turn ignition switch to "OFF".
2. Turn washer switch to "ON".
3. Check continuity between ⑭ and ②.

Check from harness side

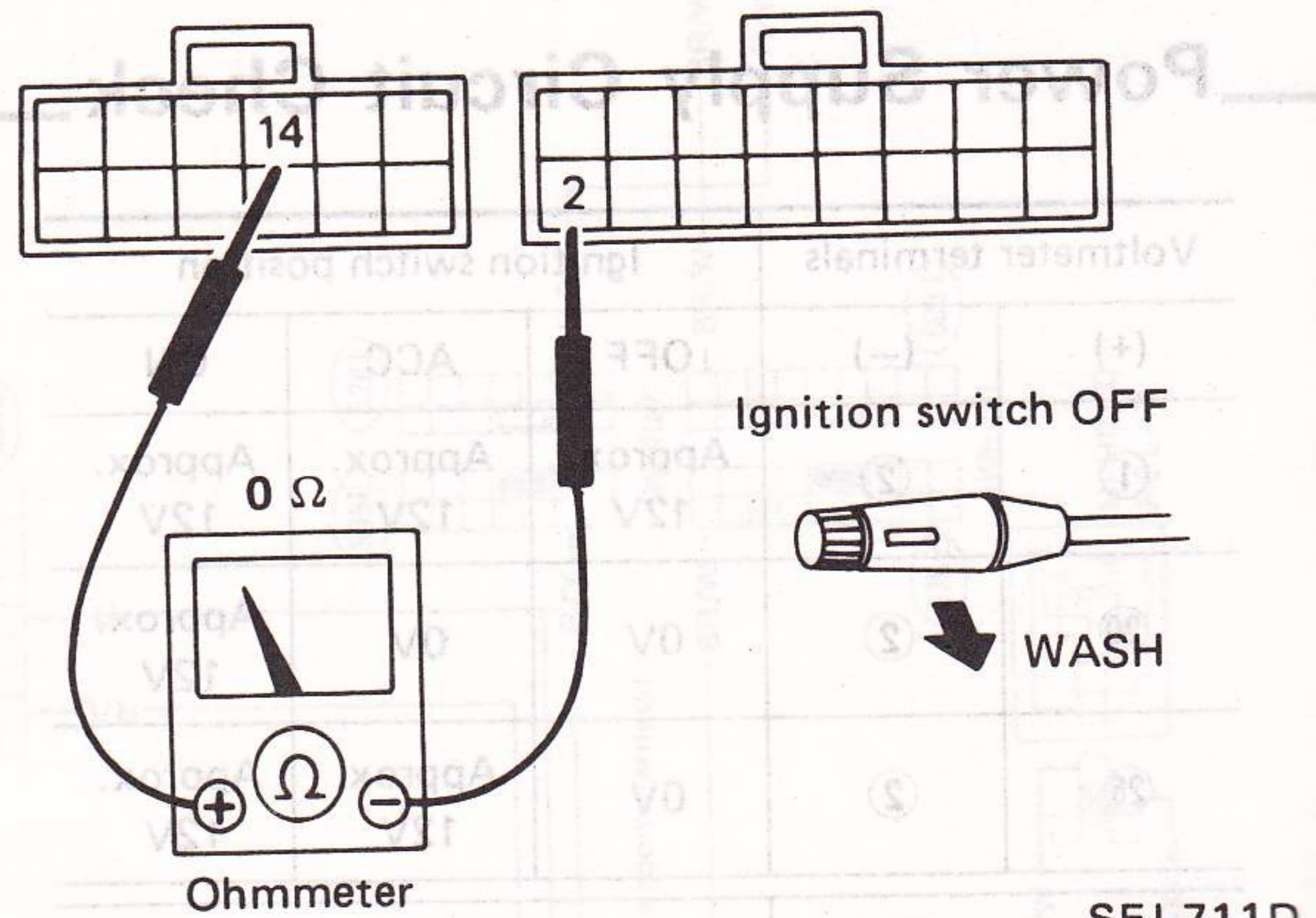

WIPER AND WASHER

Windshield Wiper and Washer/Wiring Diagram

L.H. drive model

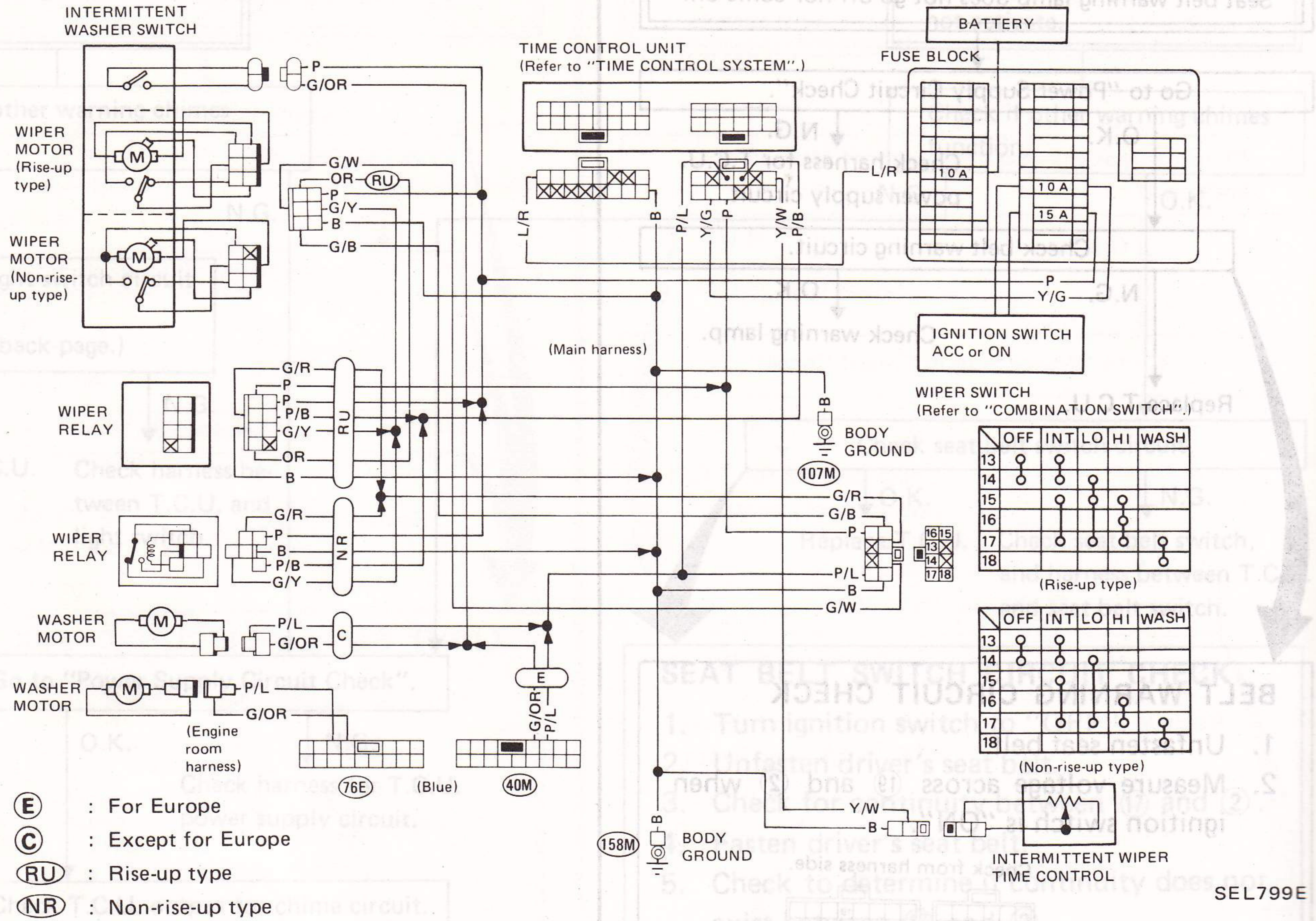

R.H. drive model

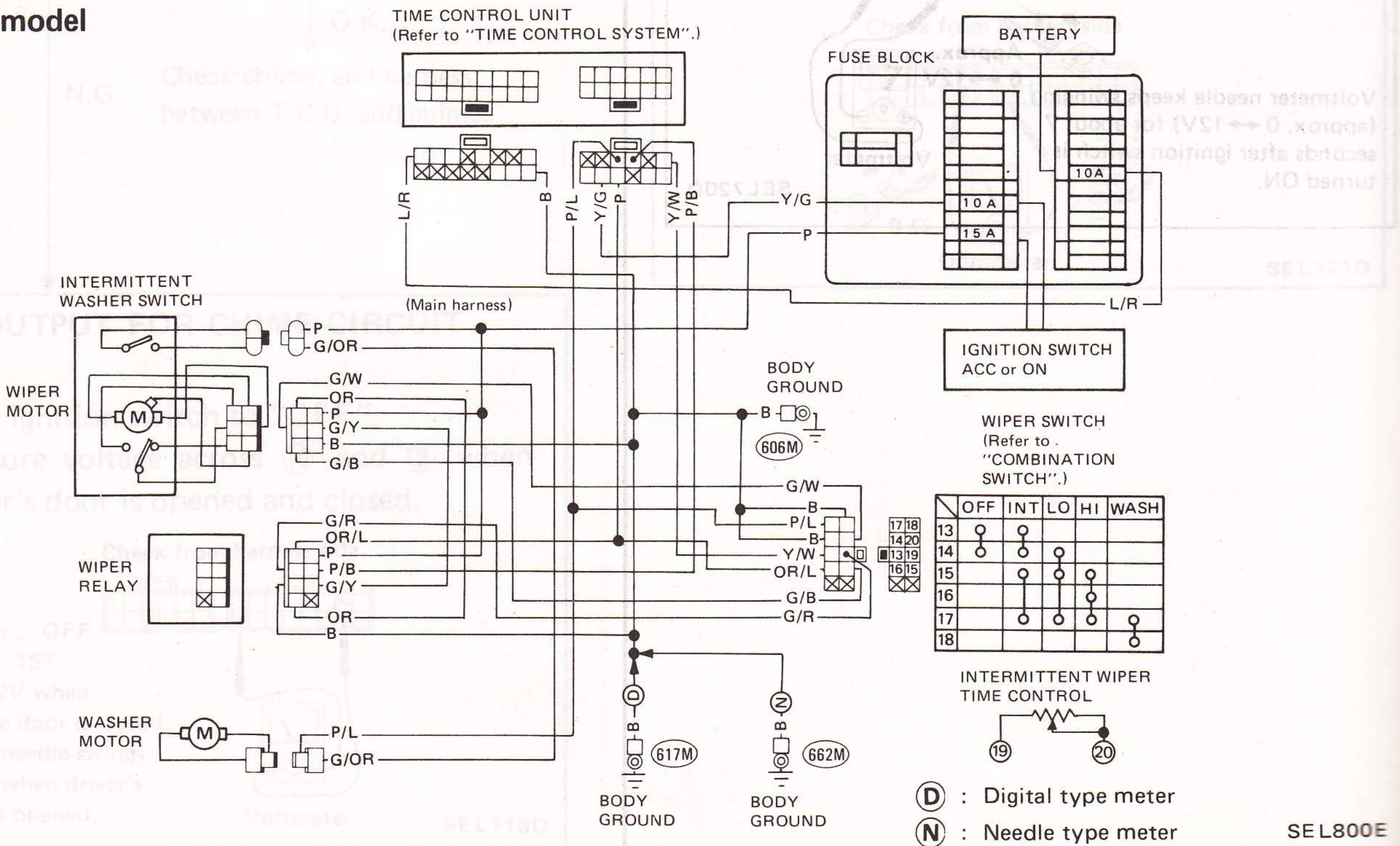

WIPER AND WASHER

Windshield Wiper and Washer/Installation

WIPER ARM

1. Prior to wiper arm installation, set wiper switch to "LOW" to operate wiper motor and then turn it "OFF" (Auto Stop).
2. Adjust wiper blades within clearance "C".
3. Tighten windshield wiper arm nuts to specified torque.

 **13 - 18 N·m (1.3 - 1.8 kg·m, 9 - 13 ft·lb)**

4. Eject washer fluid. Set wiper switch to "LOW" to operate wiper motor and then turn it "OFF".
5. Ensure that wiper blades stop within clearance "C".

Clearance "C": 15 - 25 mm (0.59 - 0.98 in)

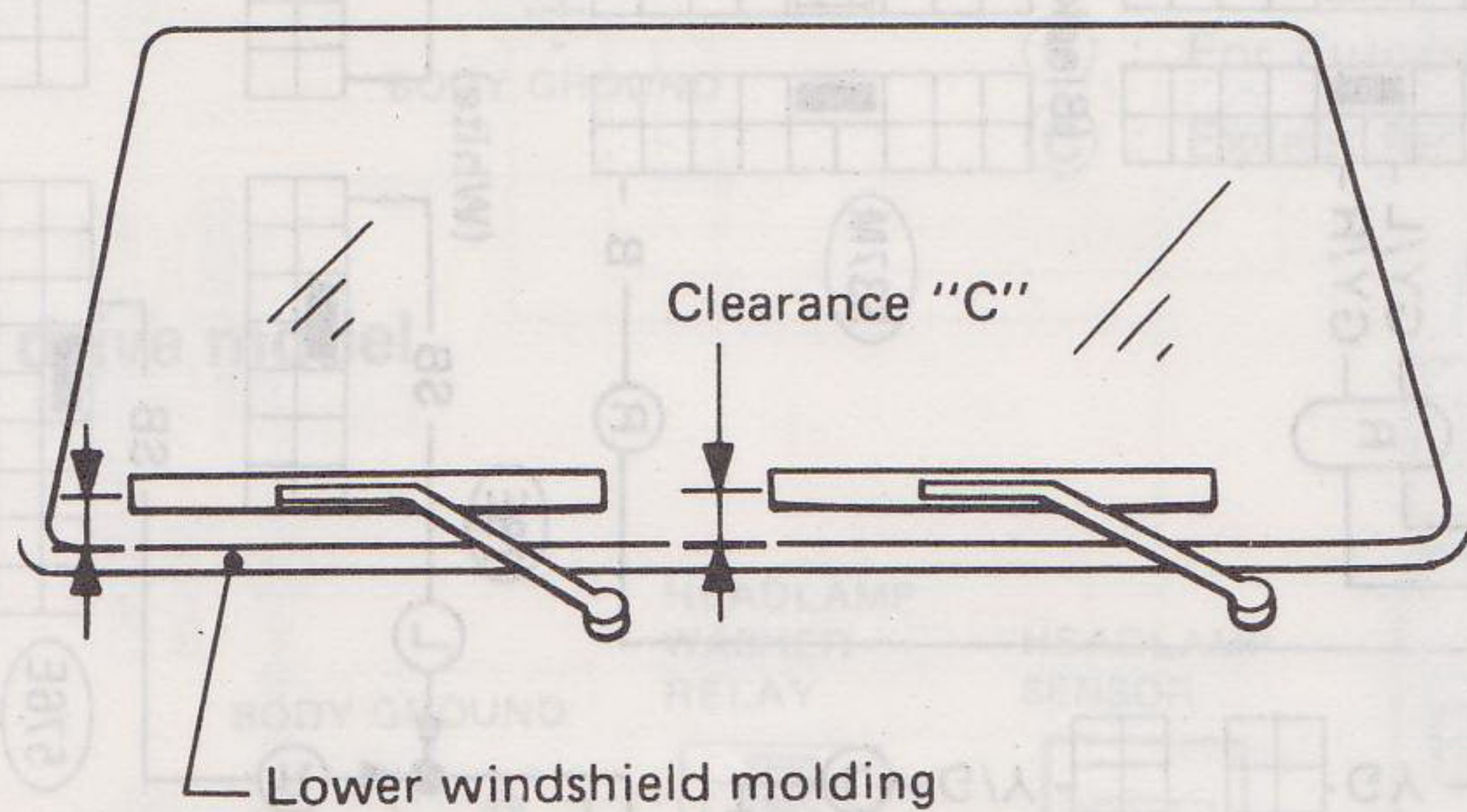

SEL355E

LOCATION OF ELECTRICAL UNITS

L.H. drive model

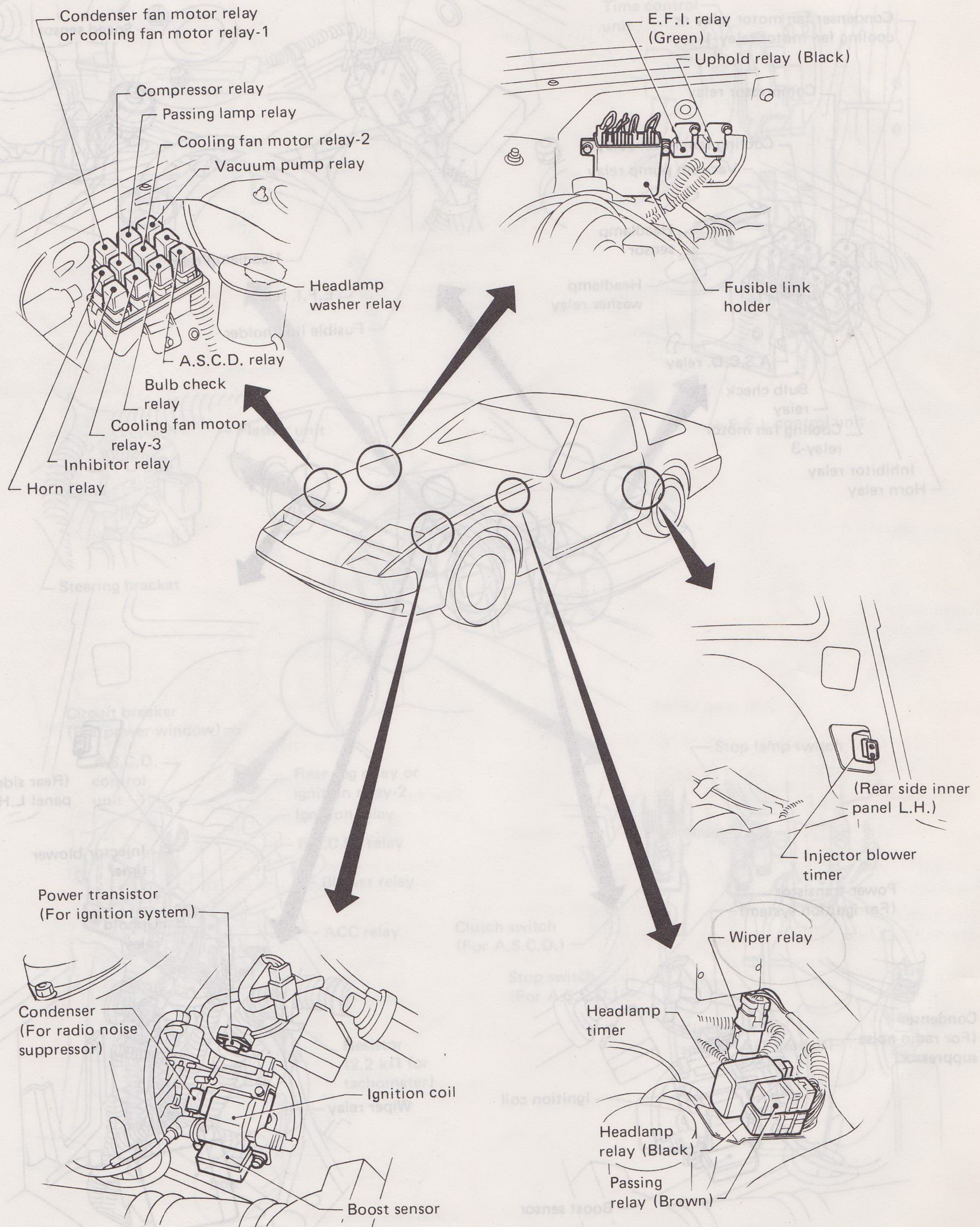

LOCATION OF ELECTRICAL UNITS

L.H. drive model

R.H. drive model

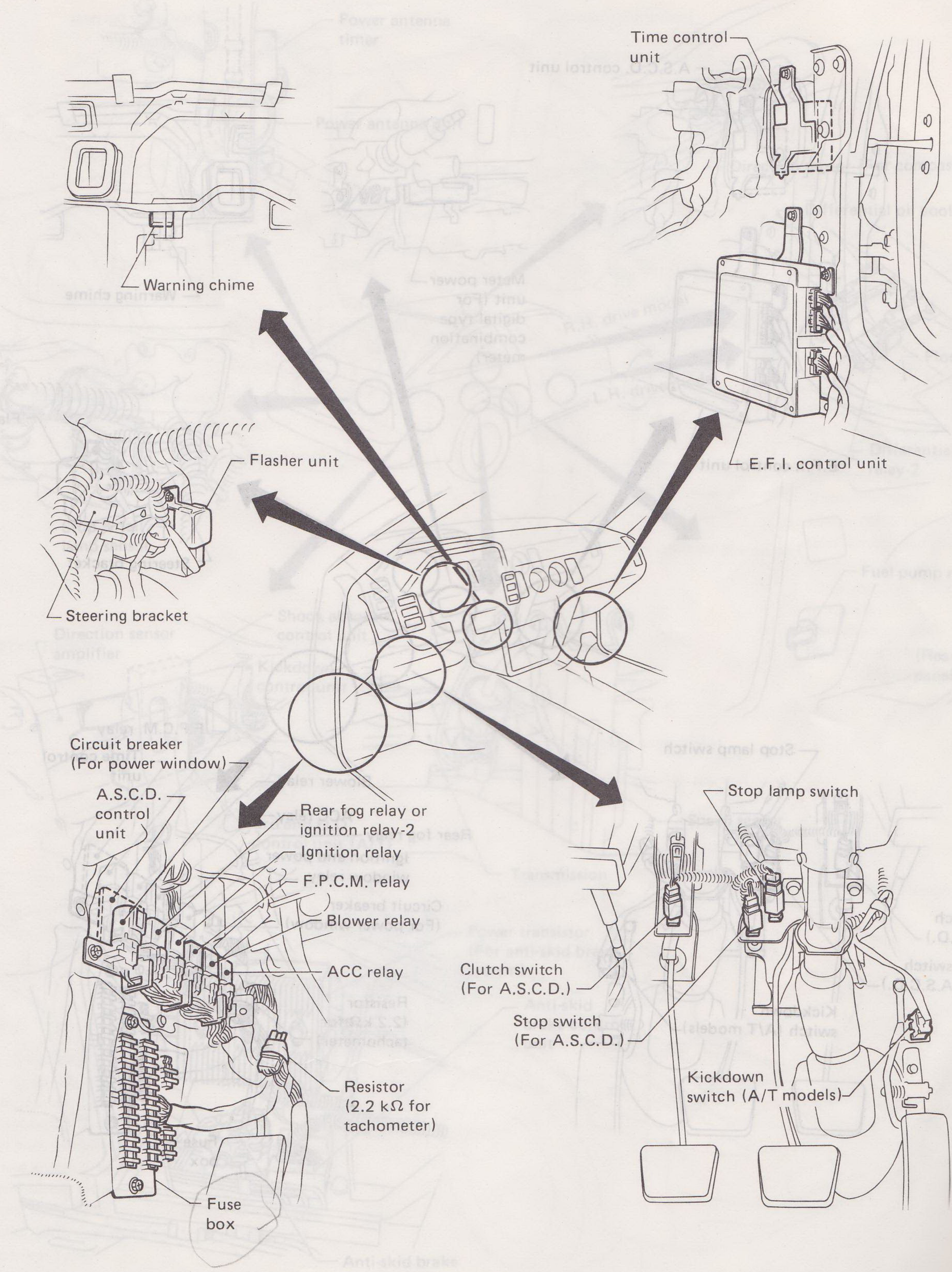

SEL863E

SEL861E

HARNESS LAYOUT

Main Harness

L.H. drive model

L.H. drive model

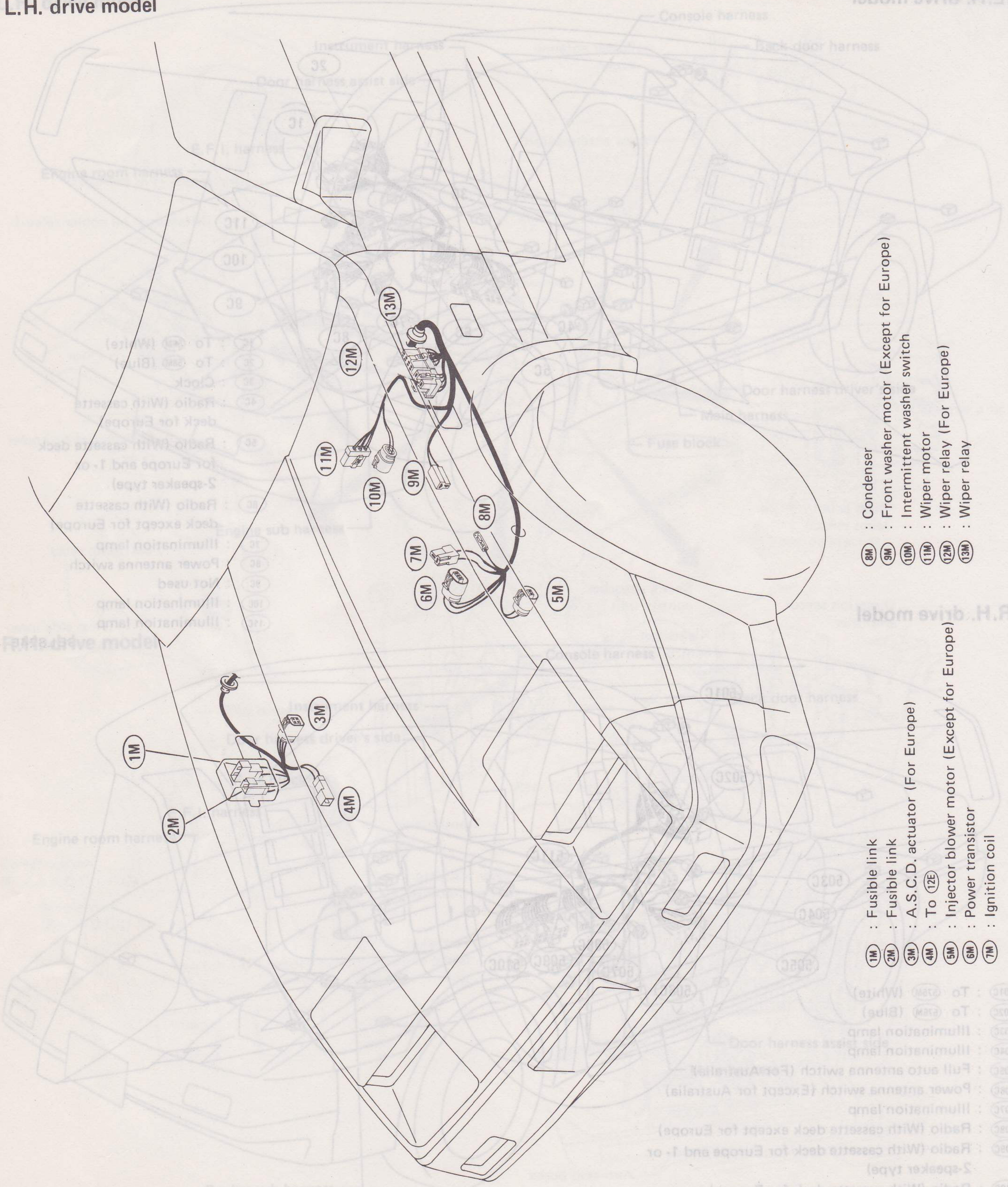

- 1M : Fusible link
- 2M : Fusible link
- 3M : A.S.C.D. actuator (For Europe)
- 4M : To (12E)
- 5M : Injector blower motor (Except for Europe)
- 6M : Power transistor
- 7M : Ignition coil

- 8M : Condenser
- 9M : Front washer motor (Except for Europe)
- 10M : Intermittent washer switch
- 11M : Wiper motor
- 12M : Wiper relay (For Europe)
- 13M : Wiper relay

SEL810E

SEL810E

HARNESS LAYOUT

Main Harness (Cont'd)

L.H. drive model

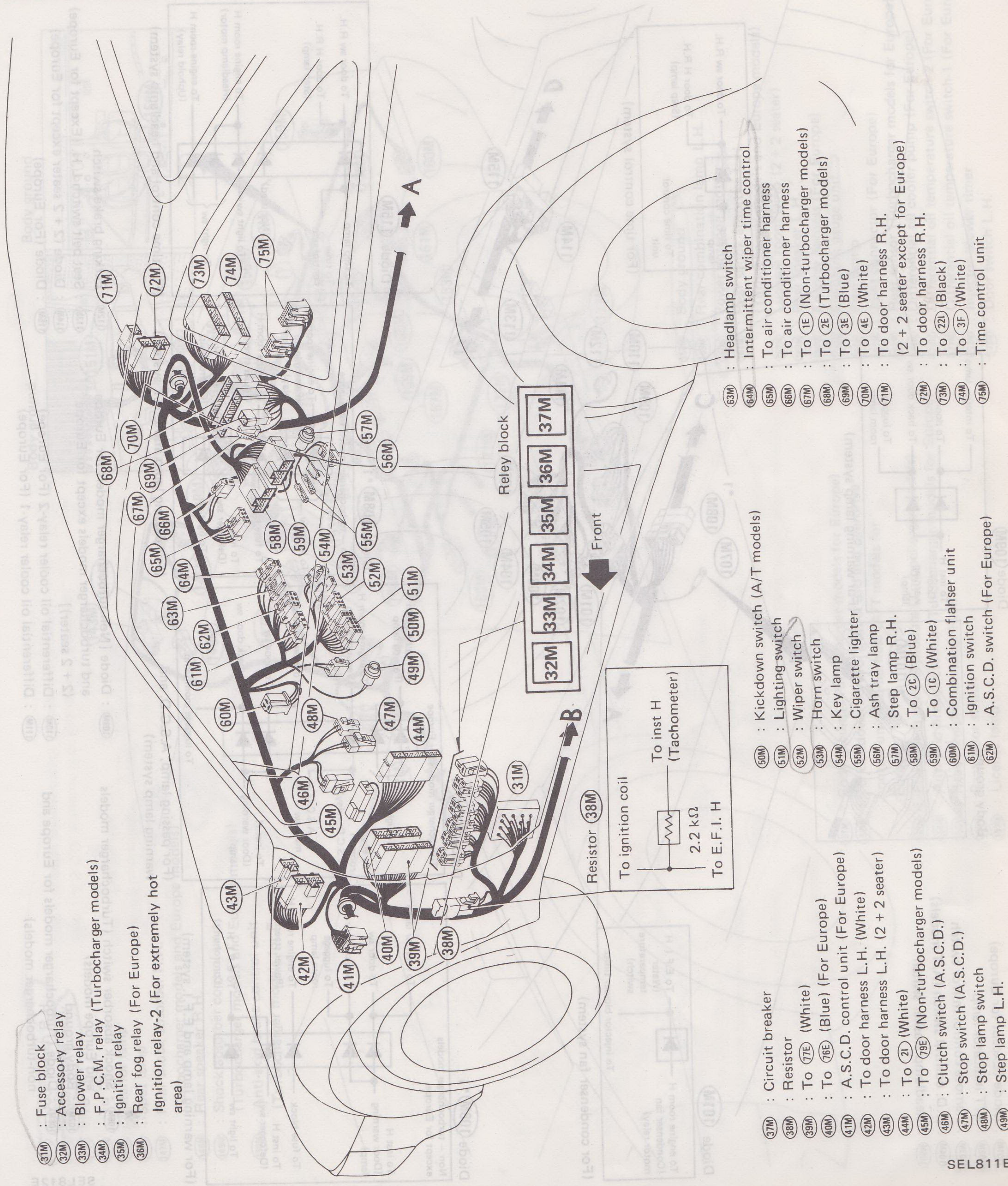

- (31M) : Fuse block
- (32M) : Accessory relay
- (33M) : Blower relay
- (34M) : F.P.C.M. relay (Turbocharger models)
- (35M) : Ignition relay
- (36M) : Rear fog relay (For Europe)

Ignition relay-2 (For extremely hot area)

- (37M) : Circuit breaker
- (38M) : Resistor
- (39M) : To (77E) (White)
- (40M) : To (76E) (Blue) (For Europe)
- (41M) : A.S.C.D. control unit (For Europe)
- (42M) : To door harness L.H. (White)
- (43M) : To door harness L.H. (2 + 2 seater)
- (44M) : To (2I) (White)
- (45M) : To (79E) (Non-turbocharger models)
- (46M) : Clutch switch (A.S.C.D.)
- (47M) : Stop switch (A.S.C.D.)
- (48M) : Stop lamp switch
- (49M) : Stop lamp L.H.

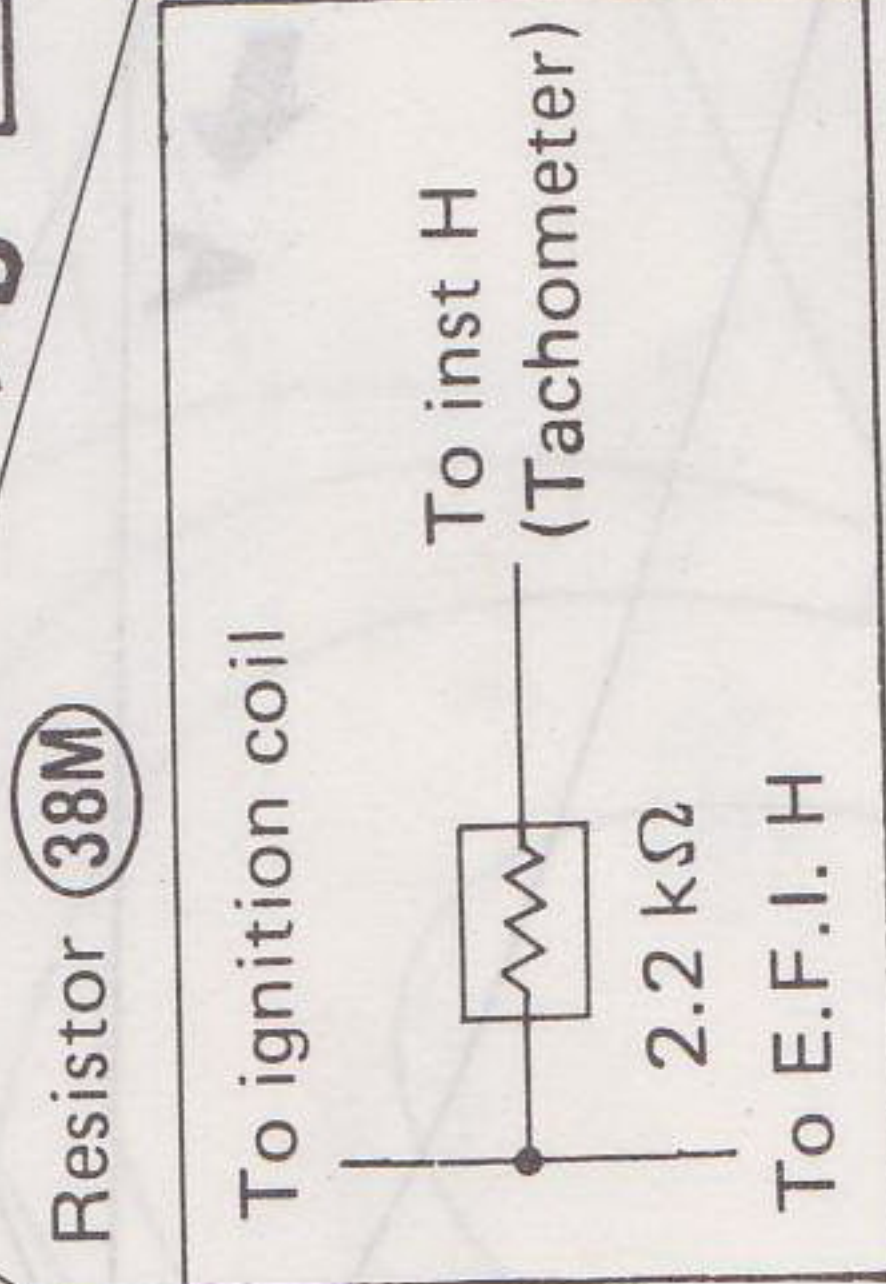

- (50M) : Kickdown switch (A/T models)
- (51M) : Lighting switch
- (52M) : Wiper switch
- (53M) : Horn switch
- (54M) : Key lamp
- (55M) : Cigarette lighter
- (56M) : Ash tray lamp
- (57M) : Step lamp R.H.
- (58M) : To (2C) (Blue)
- (59M) : To (1C) (White)
- (60M) : Combination flasher unit
- (61M) : Ignition switch
- (62M) : A.S.C.D. switch (For Europe)

- (63M) : Headlamp switch
- (64M) : Intermittent wiper time control
- (65M) : To air conditioner harness
- (66M) : To air conditioner harness
- (67M) : To (1E) (Non-turbocharger models)
- (68M) : To (2E) (Turbocharger models)
- (69M) : To (3E) (Blue)
- (70M) : To (4E) (White)
- (71M) : To door harness R.H. (2 + 2 seater except for Europe)
- (72M) : To door harness R.H.
- (73M) : To (22I) (Black)
- (74M) : To (3F) (White)
- (75M) : Time control unit